

BYGONE TREASURES ALONG THE AMELIA RIVER

GUSTAV G. GERBING and GERBING'S GARDENS

Presentation by Marianne Salas

May 13, 2022

Florida Federation of Garden Clubs, Inc.

District IV Spring Meeting

Hosted by Bartram Garden Club



1917 Survey of AMELIA ISLAND

Bound on the west by the Amelia River, north by the entrance to St. Mary's River, east by the Atlantic Ocean and South by Nassau Sound (today's Talbot Park system)

Amelia City

SKETCHES OF AMELIA ISLAND AND FERNANDINA BEACH

The Mark of William Maurer



Camellia japonica 'Otomi', 'Pink Perfection'









**Camellia japonica
'Professor Sargent'**



CAMELLIAS

By
G.G. GERBING

AMELIA

One of my own seedlings, named for the home of my Camellia Gardens, Amelia City. The red blooms have a coppery tinge. In form they are semi-double to loose peony shape, with thick petals of very fine substance. Free flowering from December through March. Shining deep green foliage, rather rounded at the tips of the leaves. A slow, stocky, upright grower. Quite hardy. A new variety released in 1944. Will stand full sun.



From a small start in 1932, I have developed my show gardens and nursery to a point where I have 250,000 Camellias and Azaleas occupying 15 acres of the ground along the banks of the Amelia River. The story of the development of the business may interest my friends and customers.

*Preface, Camellias by
G. G. Gerbing*

Gardens After 60 Years of Neglect

- Light needed for plants to flourish
 - New, Unwanted Trees
 - Vines Everywhere
 - Underbrush
 - Restore/Relocate Curbing



Gardens After 60 Years of Neglect

- Light needed for plants to flourish
 - New, Unwanted Trees
 - Vines Everywhere
 - Underbrush
 - Restore/Relocate Curbing



Gerbing Gardens Restoration

- Restore Gardens for Cottages and Common Azalea Garden Space
- Preservation of Azaleas and Camellias
 - Transplant Plants to Temporary Garden for later use as landscaping
 - Landscape new, cottage homes with original plants

Today's Survey – Gerbing Gardens

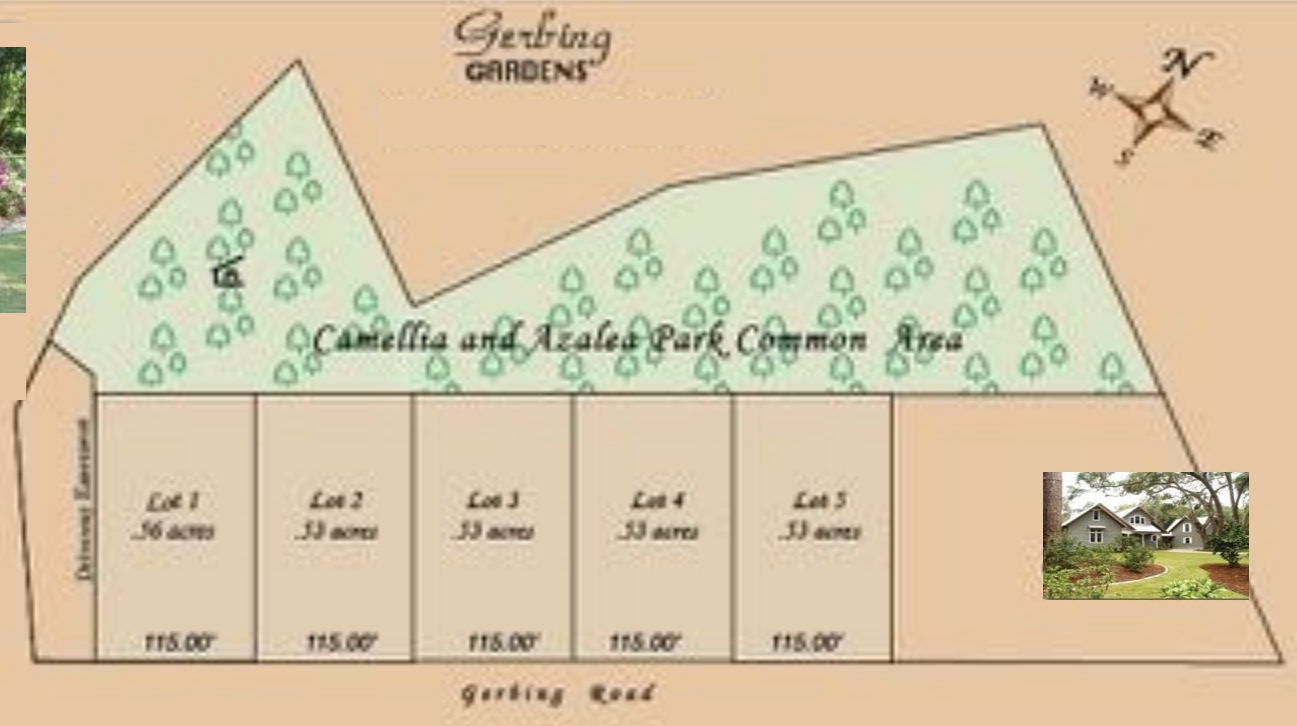

Landscaping With Original Plants







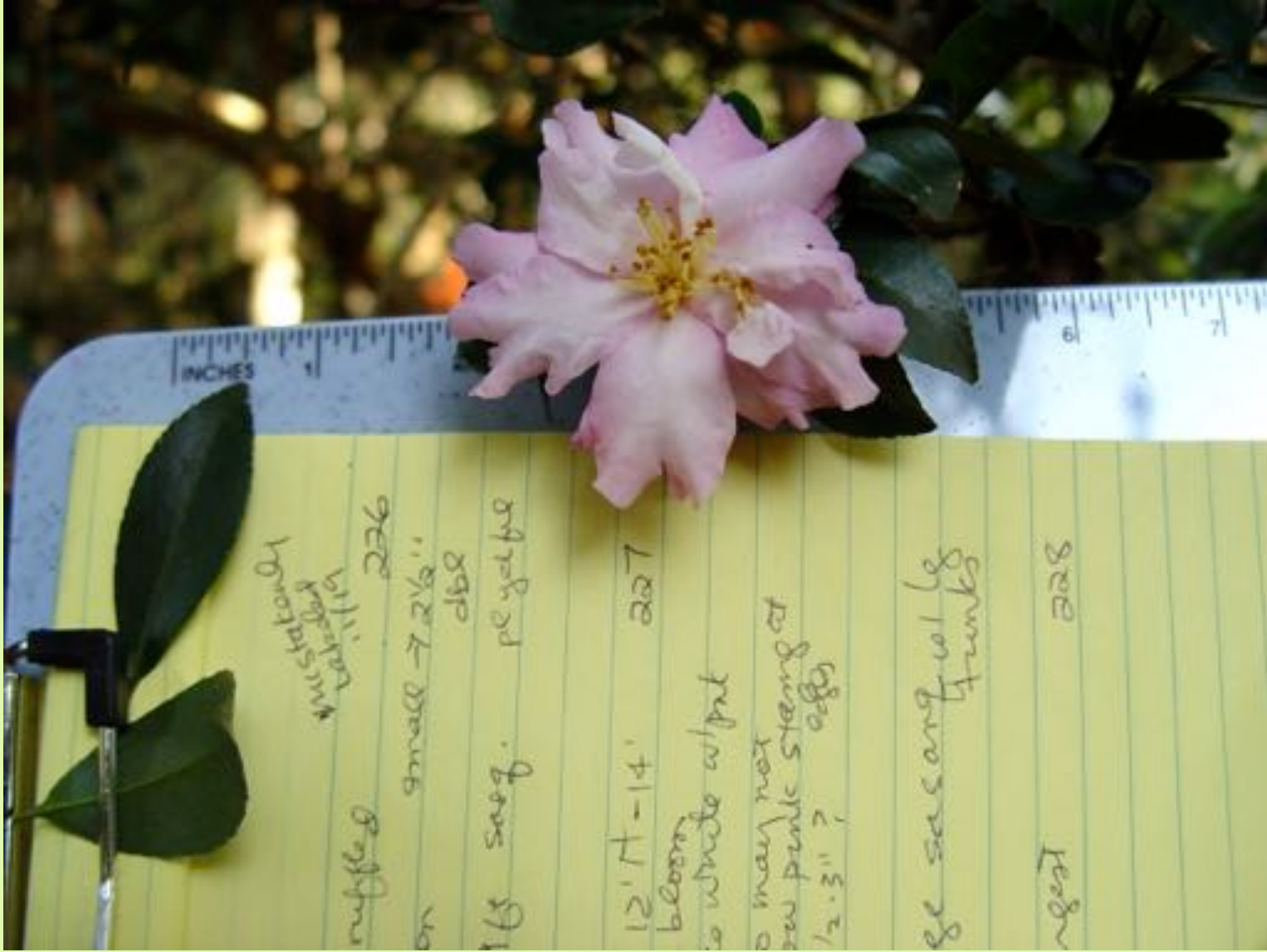

ruffled
 on 9mms → 2 1/2"
 226
 dip
 1/2 saoz. pe yellow
 227

12' 11" - 14"
 bloom
 no white w/pet
 o may not
 see pink stem at
 1/2 - 3" ?
 228

see saoz and w/ lg
 trunk
 228
 leaf



Unusual stacking of petals

Variegated foliage caused by virus







Three different bloom forms from the same tree



Two Blooms from the same tree



Gerbings Gardens,

admission in 1947, 60 cents (\$7.78 in 2022)





Azaleas and Camellias, Gerbings Gardens, Fernandina Beach, Fla.

Azalea Trails, Gerbings Gardens



Azalea Trails, Gerbings Gardens, Fernandina Beach, Fla.

Parking Area, Gerbings Gardens, Fernandina Beach, Fla.



*Calendulas Surround Pool
Gerbing's Gardens
Fernandina Beach, Fla.*



Festival of Flowers, Gerbings Gardens, 1947



MARSH - KORNEGAY, INC. JACKSONVILLE, FLA.

Sunday Afternoon

Gerbing's Gardens--2.30

**THIRD ANNUAL
BEAUTY CONTEST**

18 Lovely Little Ladies 18

ZACK (Smiling Jack) MOSLEY

Chairman Judging Committee

ADMISSION 50c and \$1.00

Including Tax

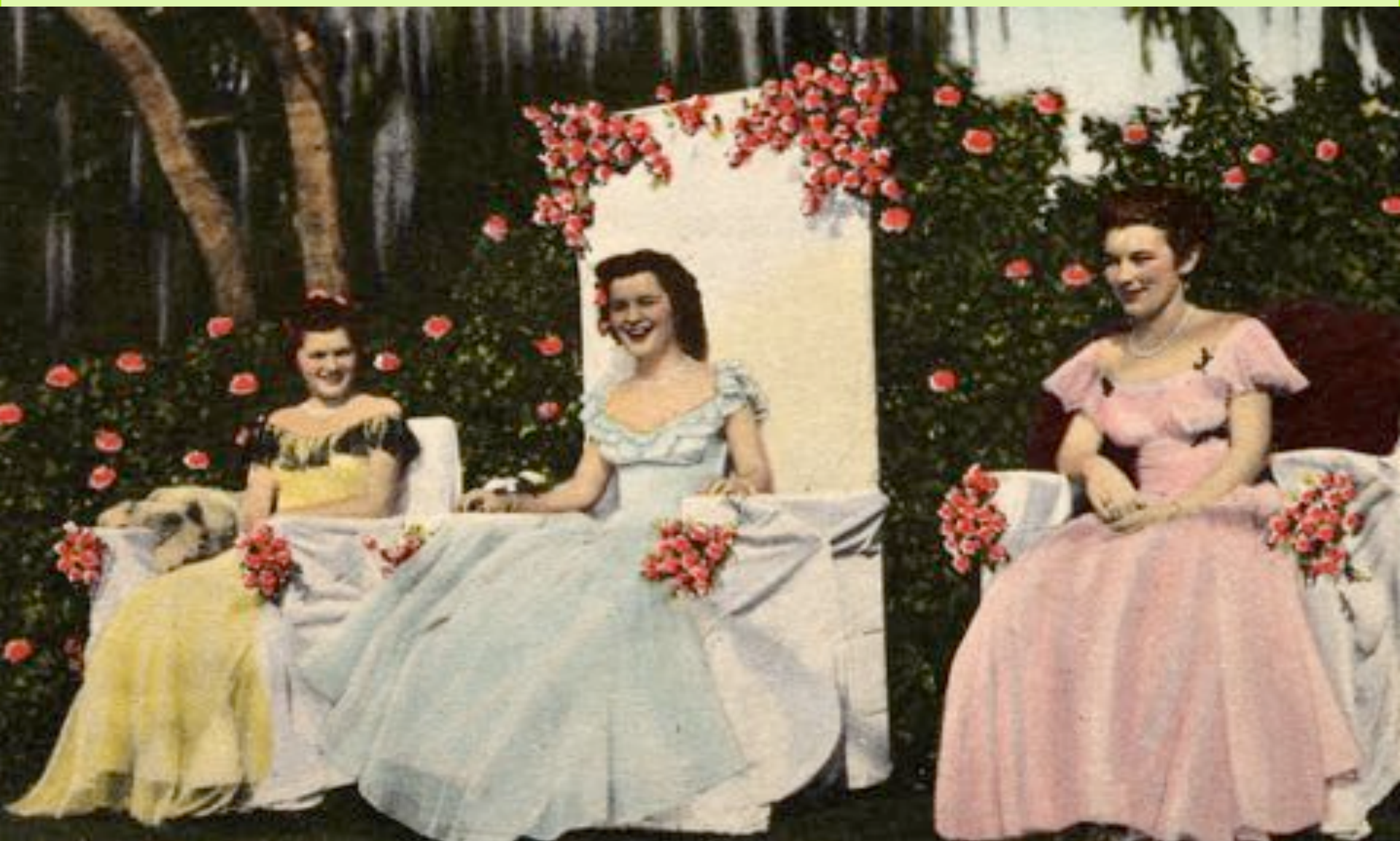

Flower Festival Queen, Gerbings Gardens, Fernandina Beach, Fla.

GUSTAV GERBING

1900 to 1982

Oyster Flats, Amelia River







Gerbing Oyster Farm



Gerbing Oyster Farm, Fernandina, Fla.

'MRS. G. G. GERBING' - *Azalea indica*



'MRS. G. G. GERBING' - *Azalea indica*



Mrs. G. G. Gerbing Azalea

Azalea indica 'Mrs. G. G. Gerbing'

SKU #00215

This time honored variety is the standard for white Satsuki azaleas. Blooms early and abundantly in medium, single pure white flowers. Dense foliage on dense spreading shrub produces a versatile landscape candidate. Ideal for urban landscapes. A natural in Asian-inspired gardens.

USDA Zone [?](#) 7-9

[Change](#)

Your climate might be too cold for this plant:

Light Needs Filtered sun

Water Needs Keep soil moist but not soggy.



Pansy Planting

By GUS GERBING



Gus Gerbing

Now is the time to get your Pansy plants planted. Prepare the bed, flower box, or edge of a bed, apply a sprinkling of 10-10 pellets on the surface where you will plant.

Take a spade or trowel and thoroughly loosen the soil mixing the pellets with the soil. Rake level and water thoroughly. Leave it for about six days before planting. Plant your Pansy plants with the roots straight down; the crown of the plant must be level with the top of the soil.

Remember that Pansies need full sun and are completely

hardy. They will start flowering about January, and will continue to flower until late June. You will have to pick off the old flowers to prevent them from forming seeds.

If you do not remove the old blossoms, they will hardly last through April or May.

Cut Worms occasionally destroy some of the plants as soon as you have planted and watered them. Dust Chlorodane dust on the plants and surrounding area, feed them about mid-December with any balanced fertilizer. Follow the directions on the package.

Members of the Men's Camellia Club meet to
discuss the flower show: Pensacola, Florida
(Florida Archives)



C008900

Members of the Men's Camellia Club meet to discuss the flower show : Pensacola, Florida



Fernandina Beach Mens Garden Club

Hal Belcher
Gus Gerbing
Ralph May
Fletcher Shurley
John Weisner



Camellia jap. "Alba Perfection"



FERNANDINA

This is one of my own seedlings, which I have named for the town of Fernandina, Florida. The large flowers of loose peony form are deep rosy red in color; they begin opening in December and continue through February. The foliage is very long, sharply pointed, deep glossy green. Dwarf and spreading in growth—inclined to be willowy. Quite hardy. This is a new variety which was released in 1944. Can be planted in full sun or shade.



FERNANDINA

Miles Beach of Magnolia Plantation Gardens and Florence Crowder, American Camellia Society



**Becky Jordi (r.), Nassau Co. Cooperative Ext.
Agent and Master Gardener**



*Camellias, by Jennifer Trehane
President, International Camellia Society*

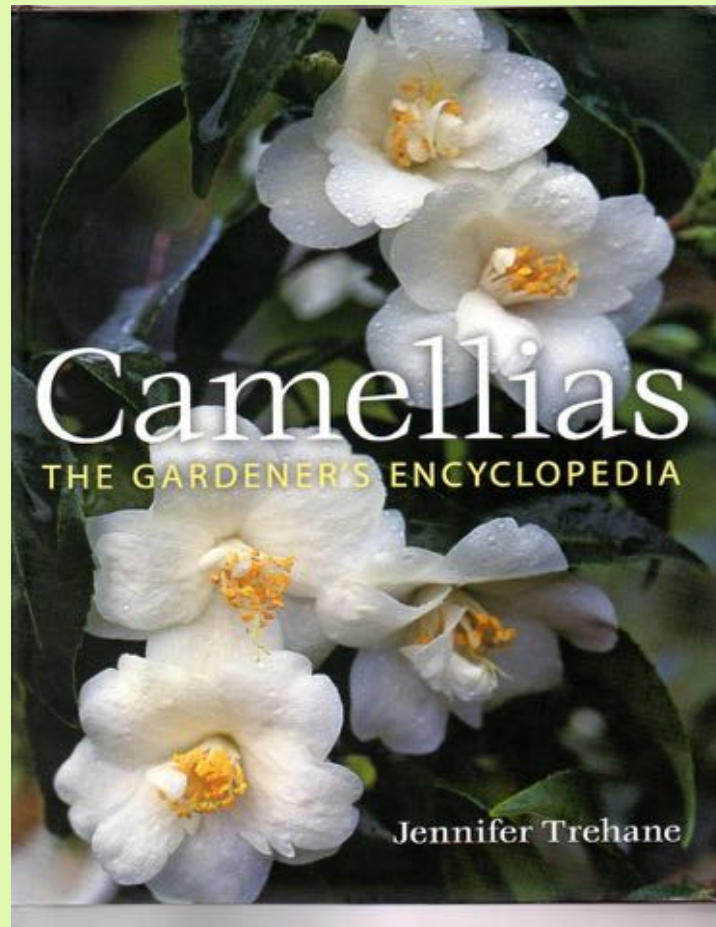

Great Gardens of America Preservation Alliance



ENTER



39





AMERICAN CAMELLIA SOCIETY, Fort Valley, GA

Tours

Gardens, mature camellias and azaleas

Nursery – plant sales

Incredible online resources for education

CAMELLIA FOREST NURSERY

CAMELLIA SHOP (originally Gene Phillips, Savannah)

Mail order camellias

Collection of *Camellia sinensis* (tea plants)

**CAMELLIA TRAIL (see American Camellia Society
website for map)**

Bamboo Gardens

Coastal Georgia Botanical Garden

**Judge Solomon's Camellias propagated
by Gene Phillips**